

Formed by likeminded residents who love Dunchurch and its heritage and wish to protect and enhance its environment in order to make the village a better place to live in, work in and visit.



FRIENDS OF  
DUNCHURCH  
SOCIETY (FODS)

Village Green House, The Green, Dunchurch, CV22 6NX Tel: 07837 182114 Email: friendsofunchurch@gmail.com

# DUNCHURCH IN BLOOM



BRITAIN IN BLOOM UK FINALIST 2020  
with the RHS



## Planning for the

## Local Wildlife Eco/Bio Project



### Dunchurch Boughton Schools

### Managed Wild Garden

### Dunchurch Library Garden

### St Peters Churchyard Wild Area 2020



FRIENDS OF DUNCHURCH SOCIETY VOLUNTEERS • FOR THE COMMUNITY • BY THE COMMUNITY  
Planting • Litterpickers • Public Space Care • Neighbourhood Watch • Village Magazine • Facebook • Website  
Village History Archive • War Memorial Care • Heritage • Dunchurch in Bloom • Members Newsletters



RUGBY IN BLOOM  
COMMUNITY  
CATEGORY



RUGBY IN BLOOM  
WAR MEMORIAL  
CATEGORY



HEART OF ENGLAND  
IN BLOOM  
LARGE VILLAGE



BRITAIN  
IN BLOOM  
with the RHS  
FINALIST FOR 2020



SEAN LAWTON AWARD FOR  
OUTSTANDING CONTRIBUTION  
TO RUGBY IN BLOOM



HEART OF ENGLAND  
IN BLOOM  
CATEGORY WINNER



HEART OF ENGLAND  
IN BLOOM OUTSTANDING  
ACHIEVEMENT

**The Site:**

**Already a garden located on the north side of the library**

**Measures~; 7m x 7m overall**

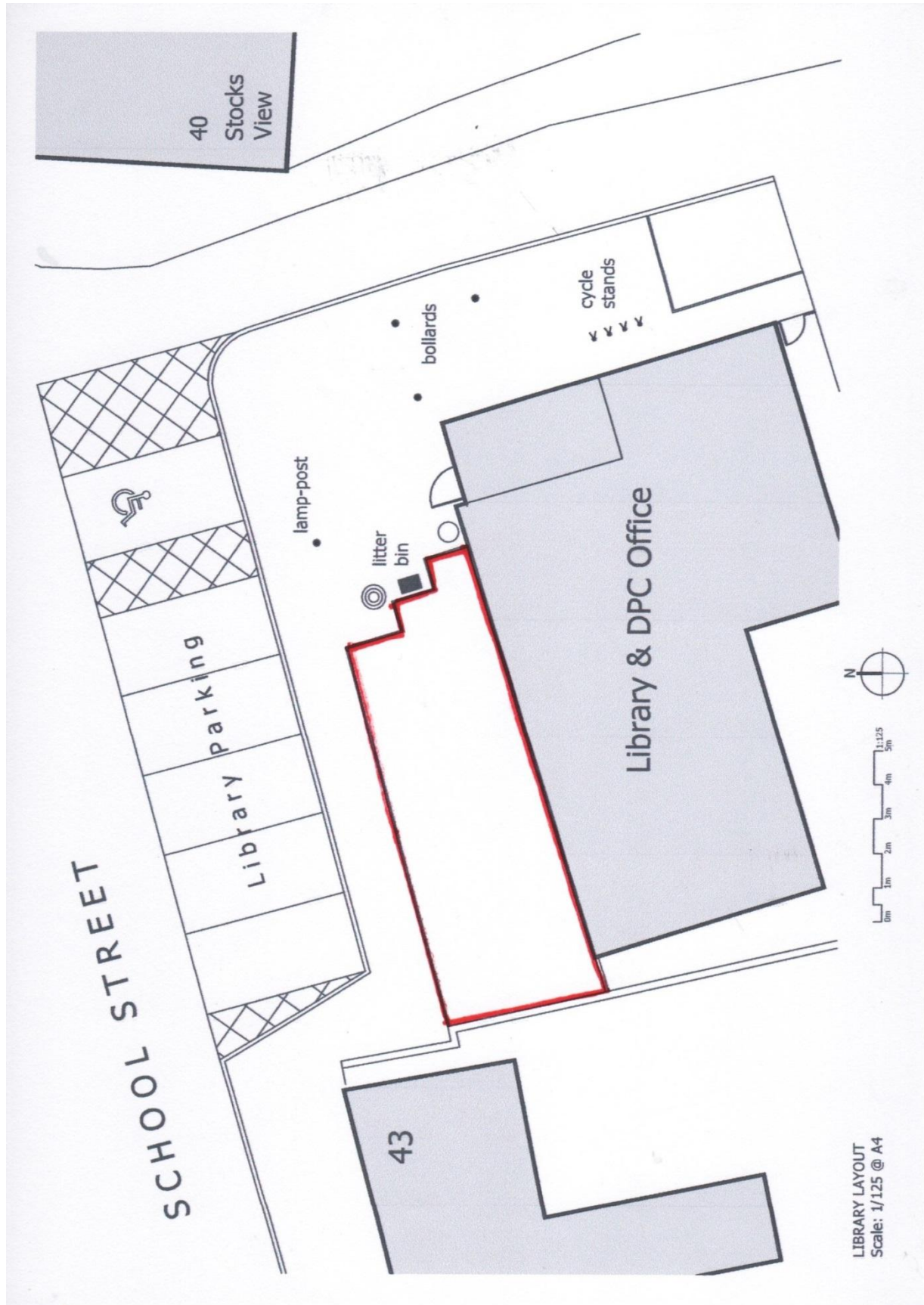

## **FODS Wildlife Friendly Objectives Wild Garden/Areas**

This project will create an eco/bio friendly environment for our local wildlife. The objective is to provide the village children and community with an micro example of what can be achieved in eco/bio conservation with a controlled wild garden. The local school children/classes will be involved in the design and maintenance of the wild area

### **Specification:**

Uncut long grass

Borders filled with flowering plants and shrubs, give nectar rich food for Butterflies and bees as well as seeds, berries and cover for birds and small mammals.

Trees, hedges and shrubs offer roosting and nesting sites for birds and mammals as well as valuable shelter and cover from the elements and possible predators.

Ponds and water features can be a habitat for a variety of animal life from amphibians and invertebrates to bathing garden birds

Wood piles can be places for animals to live, feed and hibernate in, to breed and shelter

Climbers growing up walls can provide somewhere safe to breed later.

Providing bird boxes, bat boxes and hedgehog homes, insect hotels

### **Breed and shelter:**

Butterfly friendly plants

Include: Honesty, hedge garlic, buckthorn

Deadwood, trimmings and old foliage, fungi and moss provides cover for beetles.

Tidying up and cutting back should be done late winter.

### **Forage and feed;**

Provide berry bushes and fruit trees and ivy. Nectar rich flowers will attract bees, wasps, butterflies and other insects!

Water provision is as important as providing food, a water collecting dish, a small pond or bird bath.

### **Sustainability:**

A compost heap provides a source of growing material.

Create a compost heap,

Sow only native wild flowers

Avoid pesticides use only non-toxic non chemical alternatives.

Rainwater butt water conservation

**Eco/Bio Accommodation:**

Insect hotels

Wild Bee (solitary) houses

Bird boxes for our local birds – sparrows etc. Several types to provide for local species

Bird bath

Bat boxes

Pond (wet area)

Fruit trees

Hog House

Log Store bug sanctuary

Small Tool Shed with rainwater collection butt

Site enclosure (dog proof)

**Management:**

FODS are researching these projects for the Dunchurch Parish Council, St Peters Church and Dunchurch Schools from design to planning ongoing maintenance

**SUITABLE PLANTS**

**NORTH FACING**

**SOUTH FACING**

--	--

Formed by likeminded residents who love Dunchurch and its heritage and wish to protect and enhance its environment in order to make the village a better place to live in, work in and visit.



FRIENDS OF  
DUNCHURCH  
SOCIETY (FODS)

Village Green House, The Green, Dunchurch, CV22 6NX Tel: 07837 182114 Email: friendsofunchurch@gmail.com

**DUNCHURCH IN BLOOM**



**BRITAIN IN BLOOM UK FINALIST 2020**  
with the RHS

## **Notes of Eco Project – Dunchurch Library Garden**

**Friday 17th January, 9.30am, The Old Forge, Rugby Road, Dunchurch**

**Present:** Sue Kember, Tony Kember, Barbara Harris, Phill Freeman, Cllr Jan Gee Russell, Sue Turner, Sue Protheroe, Lynne Brushett, Scott Ballard, Ian Dewes, Shenagh Hume and Elaine Reeves

This is a complex project with much to consider on many levels

Tony reported to the meeting that consultations and references have been made to:

Chris Worman MBE, FLI - Parks & Grounds Manager Rugby Borough Council

Scott Ballard - Greenspace Officer, Rugby Borough Council

RHS web site

Reading University - RHS research Water Conservation project paper

Shenagh Hume - Garden designer , Plant allergy Specialist -

Elaine Reeves, Ex Ryton Gardens

Ian Dewes - Head, Dunchurch Infant & Junior School

Please find following the notes of the meeting where Dunchurch Parish Council Office and Community Library garden was discussed.

**Ian Dewes**, Headmaster of Dunchurch Schools opened the meeting by saying he was supportive of the project.

He confirmed that a member of his staff would be appointed to coordinate on the project and the children would certainly be able to be involved both on site and in the classroom

**Shenagh and Elaine kindly agreed to be** the volunteer lead design team on this project

Shenagh and Elaine have researched the RHS judging criteria for a Wildlife friendly garden and have committed to making this the guideline for the garden design.

### **Shenagh asked: questions:**

1. Can we change the under Windows panels?
2. Is the tall wall separating the garden from the adjacent School Street property in the ownership of DPC? *DPC Councillor Jan G offered to investigate the ownership of the wall with the Councils records.*
3. Can we use the area at the rear of the library building and access this directly from the garden?

Shenagh and Elaine we told that it would be helpful if the plan drawing they will prepare was informative at A4 size and would clearly show the location of everything recommended including plants , wildlife man made facilities etc. .

Craig Beech, a local architect has produced a scale plan and and he has offered to take the final design on plan and produce from it a detailed interpretation on his CAD machine.

This facility would have several advantages including having an easily transmitted document.

Sue Kember has agreed to produce with Shenagh any illustrations required. It was also agreed it would be helpful if a list of subjects needed for colour illustrations of a hedgehog , sparrow, mouse etc could be forwarded to Sue K  
Tony Kember said that he would be pleased to act as the overall manager of this project and would be happy to address any questions, queries, concerns or issues. He would also be the coordinator with DPC (the client for this project) and RBC and agreed to advise DPC and RBC of this arrangement.

The project would be funded by the DPC and contributions from FODS volunteers.

There was a discussion on the possibility of a picket fence. RBC Green Spaces Officer recommended a green colour 'invisible green' (he may have a colour reference for this) Some sort of hedge garden side of this was suggested .  
The site should be enclosed with only one gate entrance to ensure the garden is dog proof.

It was agreed that a picket fence may require planning consent and we will engage with RBC planning dept. Tony Kember will discuss this in principle with the planners and seek their guidance.

We thought to be influenced by existing village fences would be good.

It was agreed that consultations with the school eco co ordinator must be very soon.

Clearly we need to know who our teacher contact is and fix a meeting ASAP.

It was suggested that a preliminary design and planting plan be made ready to take to school for initial meeting consultations with the teacher who may want at this visit to include the children in the classroom.

It was suggested we get contact information (email) from the appointed garden project teacher up front, Any suitable involvement of children in projects should be agreed ASAP. Suggest first meeting with school within 10 days.

**RBC involvement:** Scott Ballard was most helpful and had done much preparation for our meeting.

He provided, some helpful advice and offered us generous access to various RPC planting areas for us to take plants free of charge. He asked for us to advise him where and when we would be taking plants.

Tony Kember suggested that we email him to confirm which flower beds he is giving us access to.

He has requested that we all only contact him by email.

Tony Kember thanked Shenagh and Elaine for joining in and sharing their enthusiasm for this community project and said that we very much looked forward to working with Shenagh, Elaine and Jackie.

### **A Proposed FODS Library garden project Team was put forward**

**Team Leader:** Tony

**Design Team:** Shenagh, Elaine and Jackie

**Administrator:** Barbara Harris

**School Headmaster coordinator:** Sue Protheroe,

**Plant production and supply:** Jan G, Tracy P

**Garden Management ongoing:** FODS volunteer gardening group.

**Garden furniture production and maintenance:** Phill F

**Parish council coordinator:** Tony

**Parish Council Coordinators:** TBA

It was suggested that costings required for DPC would include:

#### **Costs of:**

Site preparation

Purchase of plants

Purchase of garden wildlife facilities boxes etc

Picket fence, gate, archway

Timber growing platform

Small garden shed and water butt

Miscellaneous items

Site Clearance

Site Planting

Tony Kember closed the meeting and thanked everyone attending for their expert input and support